



High Street, Ongar, CM5

BUTLER & STAG



**Guide Price £475,000-
£500,000.**
**A simply stunning four
bedroom end of terraced
house in a boutique gated
mews development
situated in the heart of
Ongar High Street.**



Freehold

- End Of Terraced Four Bedroom House
- Immaculately Presented Throughout With Stunning Interiors
- Open Plan Kitchen/Dining Area
- Separate Lounge
- Two Allocated Parking Spaces/Gated Development
- Detached Outbuilding/West Facing Rear Garden

Accommodation is vast with the floor space stretching in excess of 1150 sq ft making it one of the largest in the development. From the wide and welcoming entrance hall you will find access to both a large open-plan modern kitchen/ dining room along with a separate spacious lounge, the ground floor level is then complete with a W/C. To the first floor there are three double bedrooms including the master with views to the rear garden, family bathroom finished to the highest of standards & stairs leading to the fourth double bedroom positioned on the second floor.

Externally, the westerly facing rear garden has been fully landscaped by the current owners to immediately offer a welcoming approach via the French doors that lead out from the lounge straight onto the decking area. There's also a large portion of the outside space laid with artificial lawn. The garden is then complete with a detached outbuilding with running power offering various usages such as a home office/gym/games room.

St Helens Mews occupies a wonderful private location positioned in the picturesque village of Ongar. Communications are excellent with central London accessed by Epping tube station and the nearby M25 and M11 motorways.

There are good local shopping facilities available in Ongar with more comprehensive shopping in the town of Epping. The area has an excellent choice of well-regarded state and private schools.





St Helens Mews, CM5

Ground Floor
Approx. 44.33 Sq. meters (477 Sq. feet)

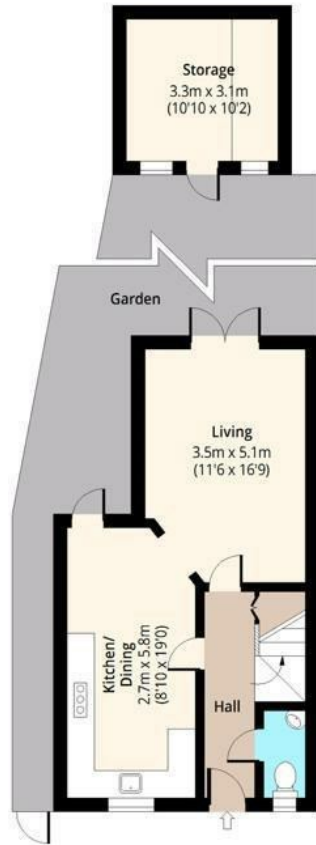

First Floor
Approx. 44.33 Sq. meters (477 Sq. feet)

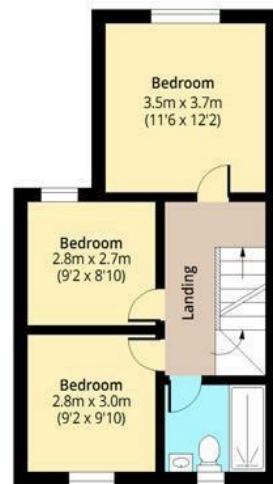

Second Floor
Approx. 18.50 Sq. meters (199 Sq. feet)

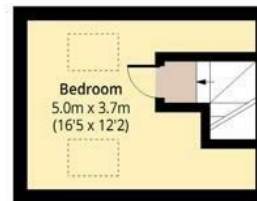

Total area: approx. 107.16 Sq. meters (1154 Sq. feet)
For illustration purposes only - not to scale
www.lpaplus.com



BUTLER & STAG

☎ 01992 667666

🏠 4 Forest Drive, Theydon Bois, Essex, CM16 7EY

✉ theydon@butlerandstag.com

IMPORTANT NOTICE - These particulars have been prepared in good faith and they are not intended to constitute part of an offer or contract. We have not performed a structural survey on this property and the services, appliances and specific fittings have not been tested. All photographs, measurements, floor plans and distances referred to are given as a guide and should not be relied upon.

www.butlerandstag.uk